

Two Bedroom Cabins

Eden East has 1 double bed with a toilet and bench sink area in one room, 2 sets of bunks in the adjoining room. Eden East sleeps 5 - 6 people.

Eden West has one room with two sets of bunks and one room containing 1 regular set of bunks and 1 due bunk (double on bottom, single on top) Eden West sleeps 8 – 9 people.

They also have table & chairs and a small fridge. You will need to bring your own bedding, towels and anything you need for eating with.

Our shared camping facilities include: Kitchen, Laundry, Toilets and Showers. Showers need a 50c coin to operate. Washing machines and dryers are \$3 ea / cycle.



EAST

WEST

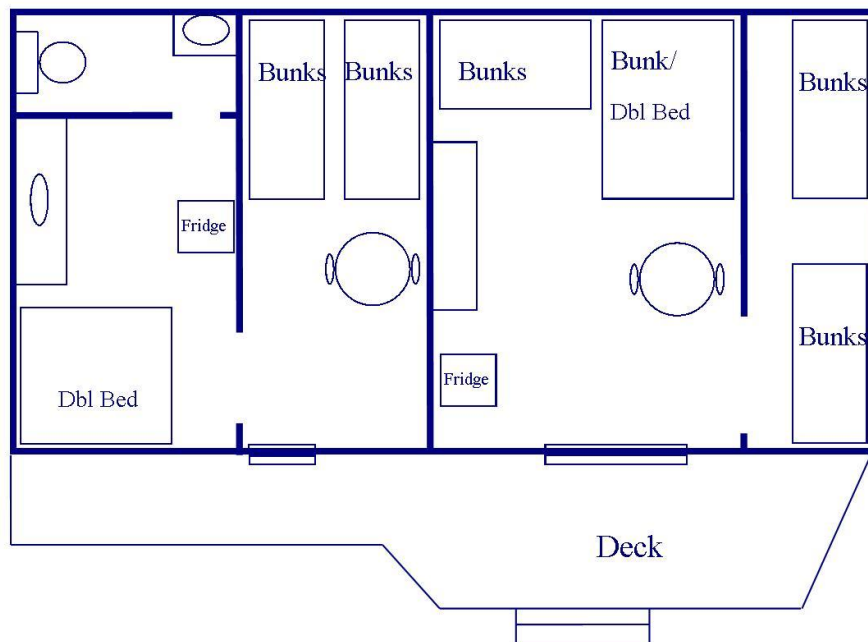

The Dept of Labour recommends that no children under 9 years to use the top bunks.